



795 Railway Tce Sawyers  
Valley 6074  
ph 0417 902 011  
or 0419 255 580



## KEY

- 1 Tree Planters/Seat
- 2 Stage 2 Art work on slatted fence To be done by Shire of Narembeen at a later date
- 3 Tree planters/no seat
- 4 Steel Cutout Barrier (see detail)
- 5 Upgrade of crossover and gradient to ensure mobility scooter access
- 6 Mountable kerb upgrade
- 7 Concrete Planter
- 8 Steel Cutout Barrier (see detail)
- 9 Additional seating to supply extra shaded seating for Coffee Shop
- 10 Upgrade gravel access alongside public toilet on Churchill Street
- 11 Upgrade directional signage for Churchill Street - TBA Shire of Narembeen
- 12 Update bins along street in high pedestrian traffic areas to match existing updated model
- 13 Local events board

Churchill Street - Focus areas - REVITALISATION

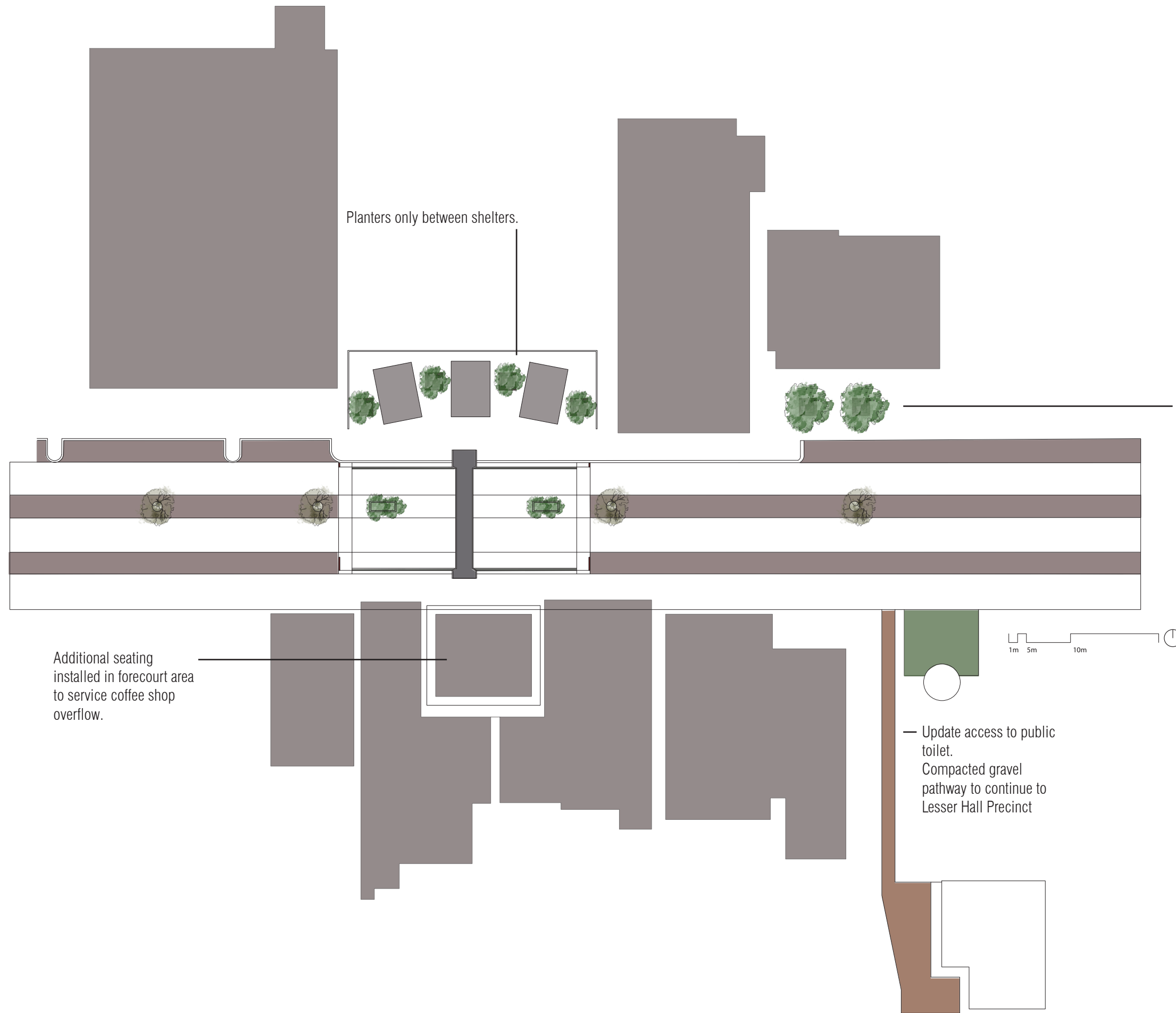

Example 1- seating and gabion baskets - to match existing seating along main street. To create a container for tree planting (see detail)



Example 2- seating and tree planter. Seats to be modified so not as deep.

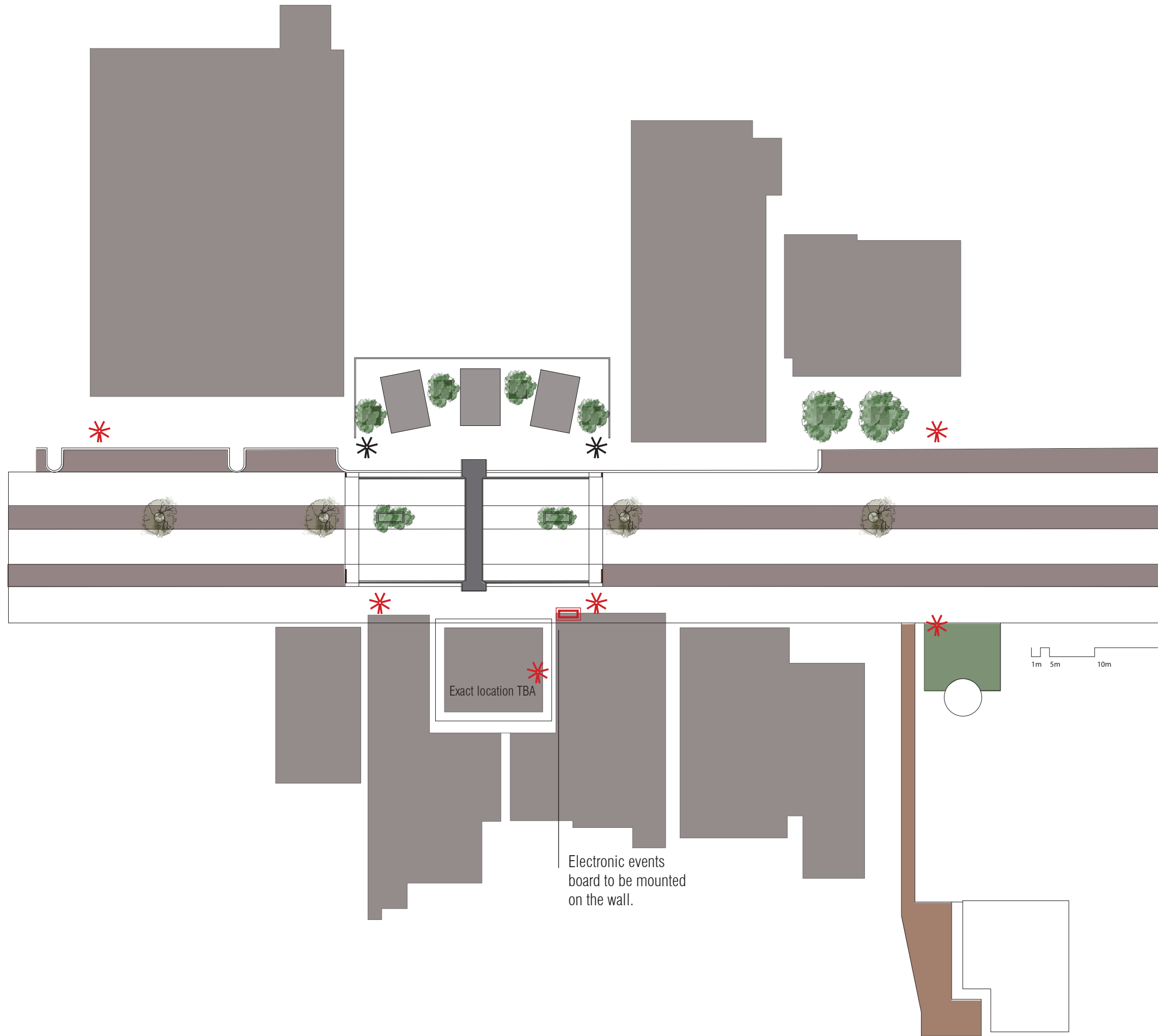

\* Location existing bins.  
Upgraded model to be the same as above. Remove all other existing bins in Churchill street

\* Location of additional bins



Events board location  
To include a QR code or interactive element so visitors can access additional local information.



Precedent - Electronic events board

Churchill Street - Focus areas -BINS & SIGNAGE



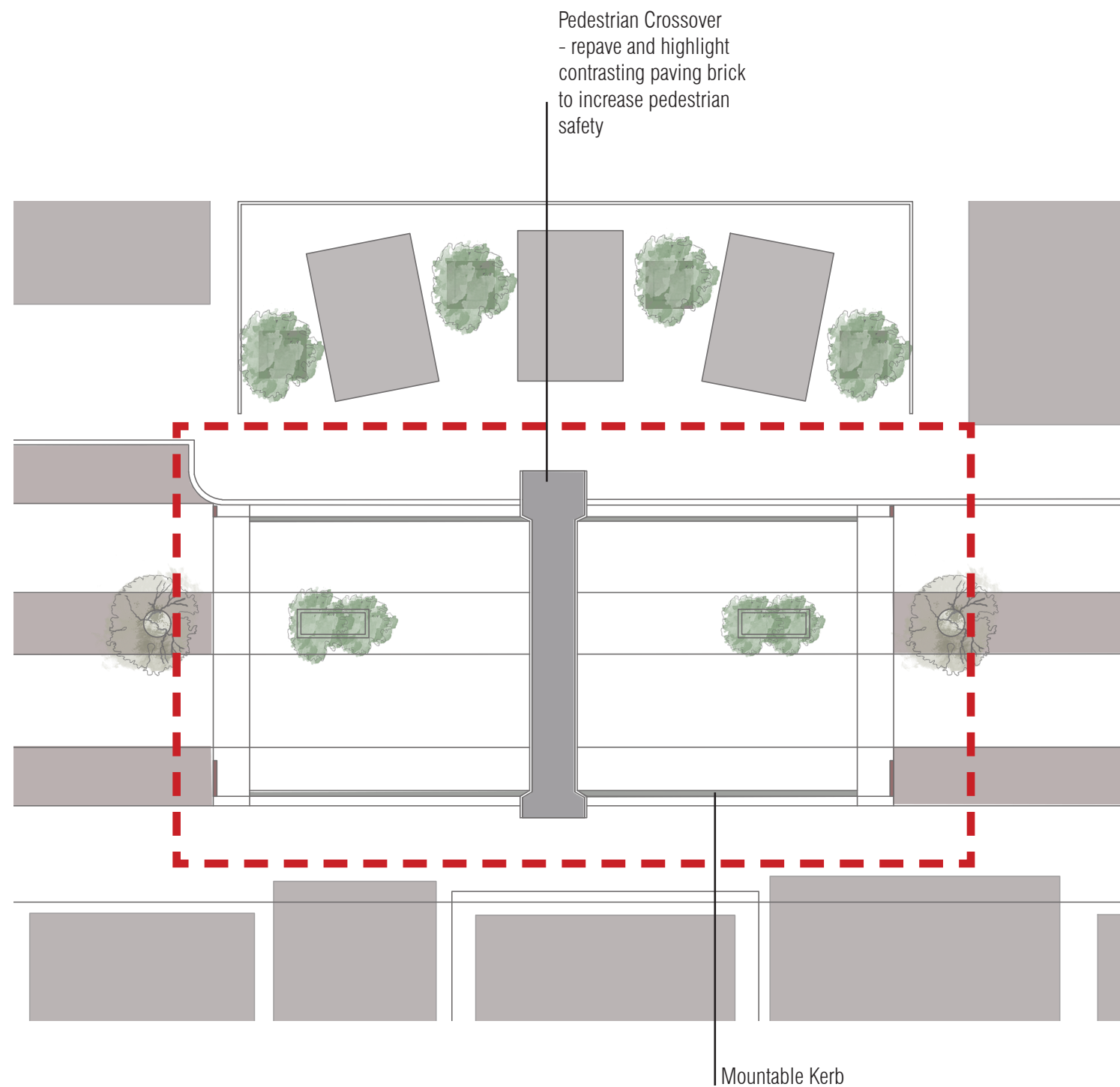

Existing crossover paving condition.  
Replace - mountable kerb and  
existing paved area.  
Incorporate contrasting crossover  
for pedestrian access.



Repaint - white road markings and  
speed limits

Additional paving areas along  
Churchill street - as identified  
by Shire of Narembreen will be  
prioritised for safety hazards.

Churchill Street - Focus areas - PAVING

STAGE 2  
Completed by Shire of Narembeen at a later date  
Reproduce or Remount  
Remount original Brass plaques on fence on western side of the slatted fence/screen.  
Opportunity to create a heritage wall of the purpose of the original area



STAGE 2  
Completed by Shire of Narembeen at a later date.  
Mount and reserve area for local artworks  
Local art work - printed onto corflute and replaced annually. Size 1200mm x 900mm  
Annual local art competition - each year a different theme.  
Smartfix aluminium hangers are designed for slatted fences or walls.

Not recommended - printing artworks onto vinyl or banner material due to high winds experienced at Narembeen.



Container for Advanced trees - min 1m square



Option 1 - Ornamental Pear  
Deciduous - replicate the species that is at the front of Lesser Hall

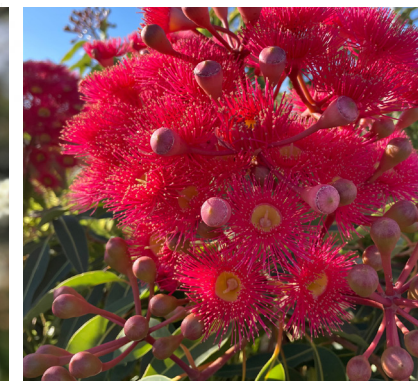

Option 2 - Corymbia Summer Red  
Evergreen- stunning summer colour and masses of flowers.



STAGE 2  
Alternative to remounting original brass  
plaques.  
Heritage wall to include copies of  
plaques and descriptive signage for  
visitors and local foot traffic.

All access cross over.  
Footpath edge to be modified to allow  
for mobility scooter crossover.  
Mountable kerb to be relaid.  
Recommend low profile concrete kerb.

Cross over 2000mm width - paved  
in contrasting colour and border to  
identify pedestrian crossing for vehicle  
traffic.  
Relay mountable kerb area and current  
paved area.  
Additional paving relay - prioritise  
safety hazards and drainage

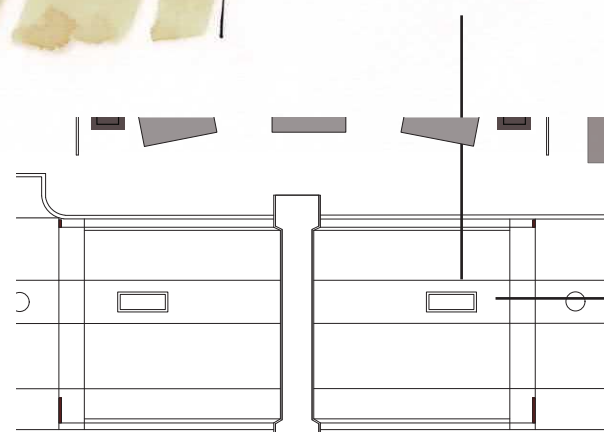

Glass reinforced Concrete (GRC) is  
long lasting, sturdy and used in many  
commercial applications.  
Opportunity for public art display by  
painting external walls or painting with  
rust oxide paint to match other planters  
Planted with same tree species that  
is selected for the additional trees on  
Churchill street.  
(Supplier/ref - City Scape- Concrete  
Planting solutions)



TALL RECTANGLE 800

DIMENSION 800 X 2200 X 1000



Regardless of option selected for the design of seating and planters some levelling of the paving will be required due to the slope on existing paving/ footpath.

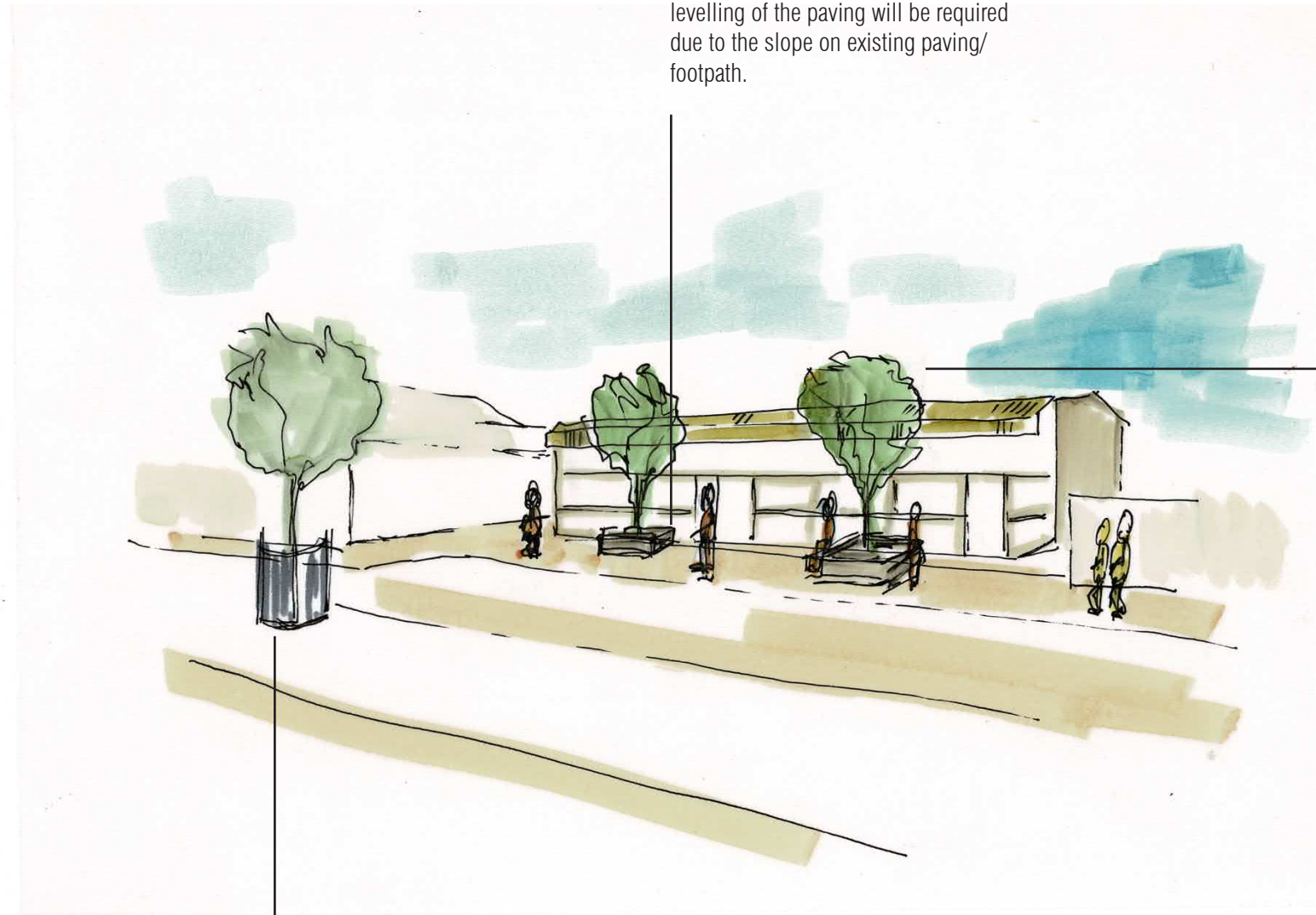

All new tree planting to be the same variety,



Option 1 - Ornamental Pear  
Deciduous - replicate the species that is at the front of Lesser Hall

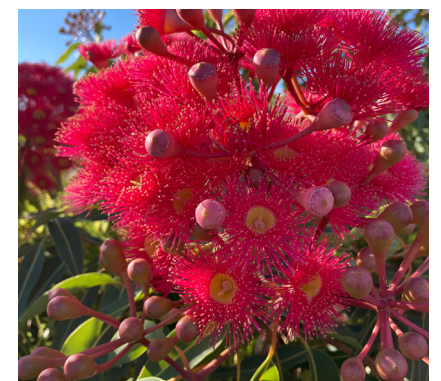

Option 2 - Corymbia Summer Red  
Evergreen- stunning summer colour and masses of flowers.

Existing tree guards to be remodelled. Spikes to be removed and painted or powder coated black.

Similar to images to right.  
If unable to remodel - update tree surrounds with black, unobtrusive modern surround.







Cross over 2000mm width – paved in contrasting colour and border to identify pedestrian crossing for vehicle traffic.

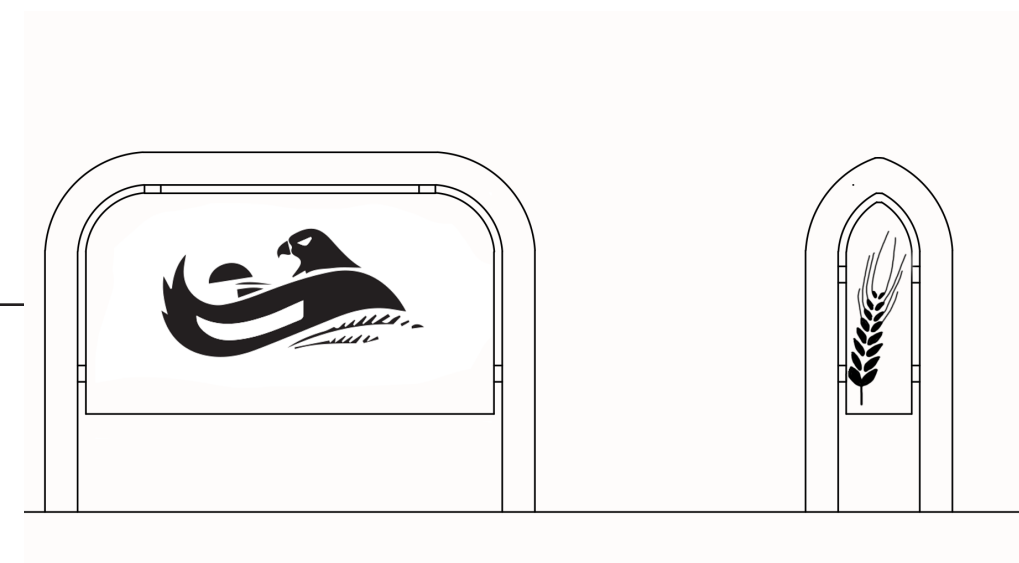

Steel Cut out Barrier x 4 (two of each)  
 North side - 400mm wide wheat logo  
 South side 1500mm - logo cut out.  
 Replace the current cement planters on drainage covers.  
 North side has a very narrow strip due to the design of the kerb and sidewalk.  
 South side has a wider area as at either end of the town square is parking reserve.